

**TFI...FKB** (SNODO-BEARING SRB...)

**TFI...T-2RS** (SNODO-BEARING SRT...2RS)

**TFI...T-2RS MAG.** (SNODO-BEARING SRT...2RS)

(SI...C; SI...TXE-2LS; SIA...TXE-2LS; GIR...UK; GIR...UK-2RS)

TERMINALI A SNODO

ISO 12240-4, SERIE E TIPO F  
ESENTI DA MANUTENZIONE

ACCOPPIAMENTO: ACCIAIO - CROMO DURO SU PTFE  
TERMINALE IN ACCIAIO C45 ZINCATO

ROD ENDS

ISO 12240-4, SERIES E TYPE F  
MAINTENANCE FREE

COUPLING: STEEL - HARD CHROMIUM ON PTFE  
HOUSING MADE OF STEEL C45 ZINC PLATED

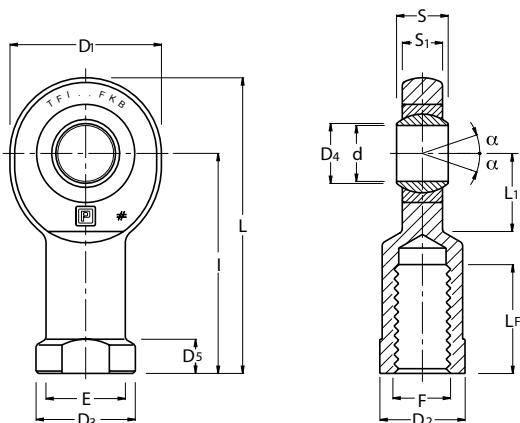

SIGLA (*) ARTICLE (*)	TOLLERANZE TOLERANCES		S	D4	I	D1	D3	E	D2	D5	S1	L	L1	LF	F	FATTORI DI CARICO LIMITE LOAD FACTORS		GIUOCO SNODO RADIALE RADIAL CLEARANCE	ANGOLO DI OSCILLAZIONE C1 SWINGING ANGLE C1	PESO IN Kg WEIGHT (kg)	
	d	S														C	Co				
	mm.	mm.														KN	mm.				
TFI 6 FKB	6	0 ± -0.008	0 ± -0.12	6	8	30	21	13	10.5	11	5	4.3	40.5	10.5	11	M 6X1	3.6	8.1	0 - 0.032	13	0.02
TFI 8 FKB	8	0 ± -0.008	0 ± -0.12	8	10.2	36	24	15	12	13	5	6	48	12	15	M 8X1.25	5.8	12.9	0 - 0.032	15	0.04
TFI 10 FKB	10	0 ± -0.008	0 ± -0.12	9	13.2	43	29	18	15	15	6.5	7	57.5	14	20	M10X1.5	8.6	17.6	0 - 0.032	12	0.06
TFI 12 FKB	12	0 ± -0.008	0 ± -0.12	10	15	50	34	20	17	18	6.5	8	67	17.5	24	M12X1.75	11.4	24.5	0 - 0.032	11	0.09
TFI 15 FKB	15	0 ± -0.008	0 ± -0.12	12	18.4	61	40	24	20	21	8	10	81	20	30	M14X2	17.6	36	0 - 0.040	8	0.18
TFI 17 FKB (T-2RS)	17	0 ± -0.008	0 ± -0.12	14	20.7	67	46	28	23	24	10	11	90	23	34	M16X2	22.4	45	0 - 0.040	10	0.22
TFI 20 FKB (T-2RS)	20	0 ± -0.010	0 ± -0.12	16	24.1	77	53	35	27.5	32	10	13	103.5	27.5	40	M20X1.5	31.5	60	0 - 0.040	9	0.35
TFI 25 FKB (T-2RS)	25	0 ± -0.010	0 ± -0.12	20	29.3	94	64	42	33.5	36	12	17	126	32	48	M24X2	51	83	0 - 0.050	7	0.64
TFI 30 FKB (T-2RS)	30	0 ± -0.010	0 ± -0.12	22	34.2	110	73	50	40	41	15	19	146.5	37	56	M30X2	66.5	110	0 - 0.050	6	0.93
TFI 35T-2RS	35	0 ± -0.012	0 ± -0.12	25	39.7	125	82	58	47	50	15	21	166	42	60	M36X3	112	146	0 - 0.050	6	1.30
TFI 40T-2RS	40	0 ± -0.012	0 ± -0.12	28	45	142	92	65	52	55	18	23	188	48	67	M39X3	140	180	0 - 0.060	7	2.01
TFI 45T-2RS	45	0 ± -0.012	0 ± -0.12	32	50.7	145	102	70	58	60	20	27	196	52	65	M42X3	180	240	0 - 0.060	7	2.50
TFI 50T-2RS	50	0 ± -0.012	0 ± -0.12	35	56	160	112	75	62	65	20	30	216	59	69	M45X3	220	290	0 - 0.060	6	3.50
TFI 60T-2RS	60	0 ± -0.015	0 ± -0.15	44	66.8	175	135	88	70	75	20	38	242	75	73	M52X3	345	450	0 - 0.060	6	5.50
TFI 70T-2RS	70	0 ± -0.015	0 ± -0.15	49	77.8	200	160	98	85	85	20	42	280	87	80	M56X4	440	610	0 - 0.072	6	8.60
TFI 80T-2RS	80	0 ± -0.015	0 ± -0.15	55	89.4	230	180	110	95	100	25	47	320	100	85	M64X4	570	695	0 - 0.072	6	12.00
VERSIONE CON FILETTO MAGGIORATO HIGHER THREAD VERSION																					
TFI 40T-2RS MAG.	40	0 ± -0.012	0 ± -0.12	28	45	142	92	65	52	55	18	23	188	48	67	M42X3	140	102.5	0 - 0.060	7	1.96
TFI 45T-2RS MAG.	45	0 ± -0.012	0 ± -0.12	32	50.7	145	102	70	58	60	20	27	196	52	65	M45X3	180	141	0 - 0.060	7	2.44
TFI 50T-2RS MAG.	50	0 ± -0.012	0 ± -0.12	35	56	160	112	75	62	65	20	30	216	59	69	M52X3	220	140	0 - 0.060	6	3.40
TFI 60T-2RS MAG.	60	0 ± -0.015	0 ± -0.15	44	66.8	175	135	88	70	75	20	38	242	75	73	M60X4	345	183	0 - 0.060	6	5.38
TFI 70T-2RS MAG.	70	0 ± -0.015	0 ± -0.15	49	77.8	200	160	98	85	80	20	42	280	87	80	M72X4	410	306	0 - 0.072	6	8.42
TFI 80T-2RS MAG.	80	0 ± -0.015	0 ± -0.15	55	89.4	230	180	110	95	100	25	47	320	100	85	M80X4	570	387	0 - 0.072	6	11.80

FORNIRE ANCHE NELLA VERSIONE CON NODO SFERICO SRLB..., SRLT-2RS, SR...TGR.

(\*) NEL CASO DI RICHIESTA CON FILETTATURA SINISTRORSA AGGIUNGERE NEL COD. ART. LA LETTERA "L" ES. TFI... - DISPONIBILITA' E PREZZO A RICHIESTA.

ALSO AVAILABLE WITH SPHERICAL PLAIN BEARING SRLB..., SRLT...-2RS, SR...TGR.

(\*) WHEN REQUIRING A LEFT-END THREAD, ADD THE LETTER "L" IN THE ARTICLE CODE, (e.g.:TFI...). AVAILABILITY AND PRICES UPON REQUEST.